

Your step by step guide to wall tiling

EASY D.I.Y.

WALL

TILING.

TILE

> DIRECT

Big Savings. Big Selection.



You can do it yourself and here's how.
Remember to take your time and you'll get a great job you can be proud of.

➤ **CHOOSE THE RIGHT TILES FOR THE JOB**

Make sure you buy the right tiles for the job. The staff at TILE DIRECT will help you with your choices for bathrooms, kitchens, patios, entrance ways, vanities, splash-backs, fire surrounds or other areas.

➤ **HERE'S WHAT YOU NEED**

- ✓ Tiles
- ✓ Tile adhesive
- ✓ Tile spacers
- ✓ Tile grout in appropriate colour
- ✓ Tape measure
- ✓ Chalk line & chalk
- ✓ Straightedge
- ✓ Spirit level
- ✓ Notched trowel
- ✓ Tile cutter/nipper
- ✓ Rubber float/squeegee
- ✓ Sponge
- ✓ Tile sealer & cleaner
- ✓ Primer
- ✓ Trims
- ✓ Waterproofing

➤ PROFESSIONAL HINTS

Avoid placing cut tiles in locations where they are easily seen, ie entrances or corners.

Plan the layout to use as many uncut tiles as you can.

Try to keep cut tiles no less than half their original size if possible and avoid narrow cut tiles.

➤ SURFACE PREPARATION

All areas to be tiled must be clean, dry and free from dust, grease, wax, curing compounds and all other contaminants. Porous surfaces must be sealed/primed.

➤ HOW TO LAY YOUR WALL TILES

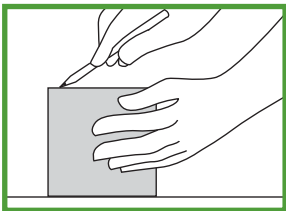

STEP 1. Using the spirit level, find the lowest point on your floor. Mark the height of a full tile on the wall. Fit a batten with its upper edge on the mark.

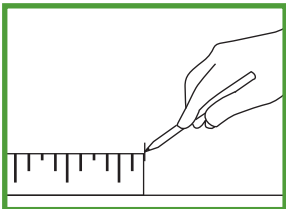

STEP 2. Measure and mark the centre of the wall, set out half a row of tiles, with the edge of the first tile lined up against the centre mark. Adjust the position of the first tile so that end tiles are not less than half their size.

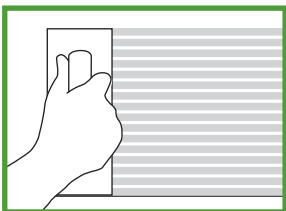

STEP 3. Using a 6mm or 8mm notched trowel, spread an even layer of ATLAS tile adhesive onto the wall above the batten over an area approximately 2 tile layers deep at a time.

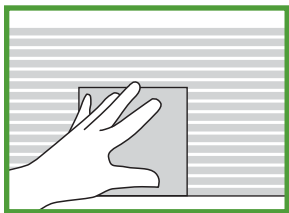

STEP 4. Moving in a horizontal direction, comb the adhesive with the notched trowel.

STEP 5. Place the first tile on the mark determined in Step 2. Press and slide tile up and back slightly into position to ensure a full bed of adhesive top and bottom.

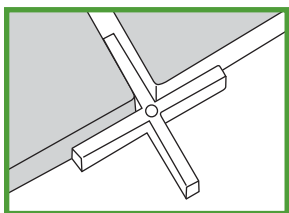

STEP 6. Working one row at a time, use small spacers between the tiles for uniform grout gaps. Check the tiling with the spirit level every two rows to ensure the tiles are straight and level. If necessary adjust gaps slightly between tile rows to ensure rows are maintained level as you progress up the wall.

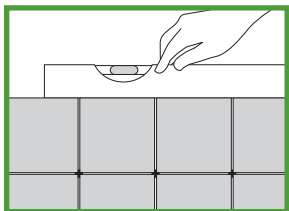

STEP 7. Measure and cut the tiles to place in the corners. Position the cut edge against the wall.

STEP 8. After adhesive has set, remove batten and fill bottom row. **REMEMBER** if you are tiling the floor, set the floor tiles in position on floor before tiling the bottom wall row.

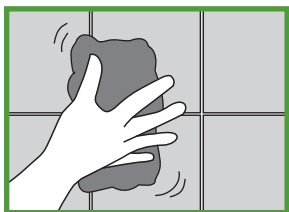

STEP 9. Allow adhesive to dry for 24 hours before commencing grouting.

Always read the back of the adhesive packaging for correct mixing and application methods.

➤ GROUTING

STEP 1. Wait approximately 24 hours until tile adhesive has set completely before commencing grouting. TILE DIRECT has a wide range of floor and wall grout to achieve the best results, which will enhance your tile selection.

STEP 2. Mix grout with water to the consistency of tooth paste.

STEP 3. Using a squeegee or rubber float work the grout into joints in a diagonal motion.

STEP 4. Wash off excess grout with a minimum amount of water using a sponge. Change water bucket frequently to give better cleaning results.

Always read the back of the Grouting bag for correct mixing and application methods.

➤ FINISHING

Any film of grout left on the tiles should be wiped off with a dry cloth, but only after grout in the joints is completely dry. You may polish or buff your tiles for a great finish.

➤ ADVICE

The team at TILE DIRECT will assist you with advice to help you with your DIY project. If you decide not to do it yourself, we can put you in touch with professional tilers who will do the job for you.

